



ABSTRACT

MGNREGS – Announcement made by Hon'ble Minister (Rural Development) for the year 2021-22 – Construction of 500 Working Sheds, 400 Sericulture Sheds and 400 Mushroom Sheds for Self Help Groups in Rural areas at a total estimated cost of Rs.84.68 Crore during the financial year 2021-22 under Mahatma Gandhi National Rural Employment Guarantee Scheme – Permission accorded – Orders – Issued.

RURAL DEVELOPMENT AND PANCHAYAT RAJ (CGS.1) DEPARTMENT

G.O.(Ms). No.139

Dated: 01.12.2021

பிலவ, கார்த்திகை 15

திருவள்ளூர் ஆண்டு 2052

Read:

1. Announcement made by Hon'ble Minister for Rural Development on the floor of the Tamil Nadu Legislative Assembly on 24.08.2021.
2. From the Director of Rural Development and Panchayat Raj, Letter Rc. No.50395/2021/MGNREGS-I-1, Dated: 16.09.2021.

ORDER:

The Hon'ble Minister (RD) made the following Announcement in the floor of the Legislative Assembly on 24.08.2021:-

“தமிழகத்திலுள்ள சுய உதவிக் குழுக்கள் மற்றும் ஊரகப் பகுதிகளில் வசிக்கும் ஏழை மக்களின் வாழ்வாதார மேம்பாடு இவ்வரசின் முக்கிய குறிக்கோள்களில் ஒன்றாகும். அதன் பொருட்டு, தனிநபர் பயன்பெறும் வகையில் 400 எண்ணிக்கையிலான பட்டுப்புழு வளர்ப்பு கூடங்கள் 27.68 கோடி ரூபாய் மதிப்பீட்டிலும், 400 எண்ணிக்கையிலான காளான் வளர்ப்பு கூடங்கள் 9 கோடி ரூபாய் மதிப்பீட்டிலும் மற்றும் 500 சுய உதவிக் குழுவினருக்கான பணிக் கூடங்கள் 48 கோடி ரூபாய் மதிப்பீட்டிலுமாக மொத்தம் 84.68 கோடி ரூபாய் மதிப்பீட்டில் 2021-22 ஆம் ஆண்டில் அமைக்கப்படும்”.

2. Based on the above Announcement, the Director of Rural Development and Panchayat Raj has furnished a proposal stating that the Para 4(1) II. (ii) of Schedule-I of the National Rural Employment Guarantee Act, 2005 envisage for Improving livelihoods through Horticulture, Sericulture, Plantation, and farm forestry. As per the Annual Master Circular 2020-21, Para 7.7.C. Common Infrastructure for Self Help Groups: Common work sheds for livelihood activities of self-help groups/ producer groups under DAY-NRLM can be taken up under Mahatma Gandhi National Rural Employment Guarantee Scheme. Only the fixed cost and not the recurring expenditure for infrastructure creation should be met with Mahatma Gandhi National Rural Employment Guarantee Scheme funds. In the "Permissible Works List" communicated by Ministry of Rural Development, Government of India, Construction of Work shed for livelihood activities for groups is approved in SI.No.67 and Under Master Category C: Common Infrastructure Including for NRLM Compliant Self-Help Groups.

3. The Common work sheds for livelihood activities of Self Help Groups / producer groups can be utilized for Mushroom Cultivation and Sericulture activities. Hence, the Director of Rural Development and Panchayat Raj has proposed to undertake the following works under Mahatma Gandhi National Rural Employment Guarantee Scheme during the financial year 2021-22 as detailed below:-

- (1) Construction of 500 Work sheds for SHGs at a cost of Rs. 48.00 Crore during the financial year 2021-22.
- (2) Construction of 400 Sericulture sheds for SHGs at a cost of Rs.27.68 Crore during the financial year 2021-22.
- (3) Construction of 400 Mushroom sheds for SHGs at a cost of Rs.9.00 Crore during the financial year 2021-22.

Selection Criteria:

- The Work Sheds, Sericulture Sheds and Mushroom Sheds will be provided to community especially for Self Help Groups under Tamil Nadu State Rural Livelihoods Mission.
- The name of selected Self Help Groups should be approved by the Grama Sabha concerned.
- The Project Director (TNSRLM) shall furnish the list of eligible SHGs approved by the Grama Sabha and send it to the Project Director (DRDA) for according Administrative Sanction by the District Collector.

Maintenance/Management of the Shed

- The Sheds after completion will be handed over to TNSRLM/SHGs.

Non-Negotiable Items:

1. Citizen Information Board shall be kept at the work site in 3 X 4 feet with all necessary information as per the framework given by the Government of India vide Ref No:K-11023/1/1/2017 – MGNREGA (IV), MoRD, Dated 07.04.2017. The

cost of Citizen Information Board will be fixed at Rs.4,500/- per unit. The cost of the Citizen Information Board shall be included in the estimate itself.

2. Estimate creation, Administrative sanction and Technical sanction shall be done in SECURE software.
3. The Notified Wage Rate as per G.O. (Ms.) No.60, Rural Development and Panchayat Raj (CGS.1) Department, Dated: 15.04.2021 and the Rural Schedule of Rates finalised in G.O. (Ms.) No.74, Rural Development and Panchayat Raj (CGS.1) Department, Dated:07.06.2021 shall be adopted. In case of any revision made in Rural Schedule of Rates in future, the same shall be adopted.

In addition to the above said guidelines, the following shall also be adhered to, during the execution of works:-

- Resolution should be obtained for in the Gram Sabha for all the selected works and it should be entered work wise in Register No.2 of Mahatma Gandhi NREGA of village panchayats concerned.
- If required, the enclosed type design may be modified by the District Collector as per the site condition and field requirement in consultation with Sericulture Department / Horticulture Department.
- If any scheme from Sericulture / Horticulture Department is converged with these works that portion of the amount have to be considered as savings from MGNREGS.

Funding pattern

Construction of 500 Work sheds for SHG:

500 Working sheds for SHGs will be constructed at an estimated cost of Rs.48.00 Crore at a unit cost Rs.9.60 Lakh. Out of which the Labour Component is Rs.3.28 Crore and Material Component is Rs.44.72 Crore with Labour Material ratio of 6.83:93.17.

(Rupees in Crores)

Description	Material Component (93.17%)			Labour Component (6.83%) (Central Share 100%)	Grand Total
	Central Share (75%)	State Share (25%)	Total		
Cost of SHG Working Shed = 9.60 Lakhs. Cost for 500 No's of SHG Working sheds = Rs.4800.00 Lakhs = (Rs.48.00 Crores)	33.54	11.18	44.72	3.28	48.00

Construction of 400 Sericulture sheds for SHGs:

400 Sericulture sheds for SHGs will be constructed at an estimated cost of Rs.27.68 Crore at a unit cost Rs.6.92 Lakhs during the financial year 2021-22 under Mahatma Gandhi National Rural Employment Guarantee Scheme. Out of which the Labour Component is Rs.1.74 Crore and Material Component is Rs.25.94 Crore with Labour Material ratio of 6.29:93.71.

(Rupees in Crores)

Description	Material Component (93.71%)			Labour Component (6.29%) (Central Share 100%)	Grand Total
	Central Share (75%)	State Share (25%)	Total		
Cost of Sericulture Shed = 6.92 Lakhs. Cost for 400 No's of Sericulture sheds = Rs.2768.00 Lakhs =(Rs.27.68 Crores)	19.46	6.48	25.94	1.74	27.68

Construction of 400 Mushroom sheds for SHGs :

400 Mushroom sheds will be constructed at an estimated cost of Rs.9.00 Crore at a unit cost of Rs.2.25 Lakhs. Out of which the Labour Component is Rs.1.03 Crore and Material Component is Rs. 7.97 Crore with Labour Material ratio of 11.44:88.56.

(Rupees in Crores)

Description	Material Component (88.56%)			Labour Component (11.44%) (Central Share 100%)	Grand Total
	Central Share (75%)	State Share (25%)	Total		
Cost of Mushroom Shed = 2.25 Lakhs. Cost for 400 No's of Mushroom sheds = Rs.900.00 Lakhs =(Rs.9.00 Crores)	5.98	1.99	7.97	1.03	9.00

The unit cost for the above works are calculated based on the Standard type design and Rural Schedule of Rates 2021-22. However, the actual estimate may vary according to the site condition and issue of PWD Schedule of Rate. The Labour cost is borne 100% by the Government of India and the material cost is shared at the ratio of 75:25 by the Government of India and the State Government.

4. Therefore the Director of Rural Development and Panchayat Raj has requested the Government to accord permission for the Construction of 500 Working Sheds, 400 Sericulture Sheds and 400 Mushroom Sheds for Self Help Groups in Rural areas at a total estimated cost of Rs.84.68 Crore during the financial year 2021-22 under Mahatma Gandhi National Rural Employment Guarantee Scheme.

5. The Government, after careful examination, have decided to accept the proposal of Director of Rural Development and Panchayat Raj and accord permission for the Construction of 500 Working Sheds, 400 Sericulture Sheds and 400 Mushroom Sheds for Self Help Groups in Rural areas at a total estimated cost of Rs.84.68 Crore during the financial year 2021-22 under Mahatma Gandhi National Rural Employment Guarantee Scheme, subject to the condition that the Financial sanction shall be made only after receipt of Government of India share and the expenditure should be accommodated within the Annual Action Plan. The Model estimates and type design are enclosed as Annexure-I, II, III, IV, V & VI.

6. This order is issued with the concurrence of Finance Department vide its U.O.No.53825/Fin(RD)/2021, dated 30.11.2021.

(BY ORDER OF THE GOVERNOR)

**P. AMUDHA,
PRINCIPAL SECRETARY TO GOVERNMENT**

To

The Director of Rural Development and Panchayat Raj, Chennai-15.

All District Collectors (except Chennai District).

(through the DRD&PR, Chennai-15)

All Project Directors, DRDA (through the DRD&PR, Chennai-15)

The Accountant General, Chennai-18.

Copy to:

The Pay and Accounts Officer (South), Chennai-35.

The Finance (RD) Department, Chennai-9.

The Chief Minister's Office, Secretariat, Chennai-9.

The Senior Personal Assistant to Hon'ble Minister (RD), Chennai-9.

The Principal Private Secretary to Principal Secretary
to Government, RD & PR Department, Chennai-9.

The National Informatics Centre, Secretariat, Chennai-9.

Stock file / Spare copy

//FORWARDED BY ORDER//

SECTION OFFICER.



Annexure-I

G.O.(Ms). No.139, Rural Development and Panchayat Raj (CGS.1) Department, dated 01.12.2021.

Model Estimate for Construction of SHG working Shed under MGNREGS

Estimate Amount : 960000

DETAILED CUM ABSTRACT ESTIMATE

S. No	Description of work	No	L	B	D	Contents	Rate/Per	Amount
1	Earth work excavation for foundation in all soils such as red earth ,hard stiff clay soil, stiff black cotton soil, hard reearth,shales, murrams, gravel,hard rock not requiring blasting etc complete.,For Foundation							
	I Depth							
	Main Column	8	1.50	1.50	0.30	5.40		
	Dummy column	2	1.20	1.20	0.30	0.86		
	For grade beam alround	1	27.92	0.45	0.30	3.77		
	ramp	1	4.50	3.80	0.30	5.13		
	D/F Column Post	8	1.50	1.50	0.30	-5.40		
	D/F Dummy post	2	1.20	1.20	0.30	-0.86		
						8.90	260.56	2319
	II Depth							
	Main Column	8	1.50	1.50	0.30	5.40		
	Dummy column	2	1.20	1.20	0.30	0.86		
	For grade beam alround	1	27.92	0.45	0.10	1.26		
	D/F Column Post	8	1.50	1.50	0.10	-1.80		
	D/F Dummy post	2	1.20	1.20	0.10	-0.29		
						5.43	321.64	1747
	III Depth							
	Main Column	8	1.50	1.50	0.90	16.20		
	Dummy column	2	1.20	1.20	0.90	2.59		
						18.79	334.06	6277
2	Supplying and filling with filling sand in layers not more than 15 cm thick ,well rammed, wattered and compacted etc,complete For Foundation							
	Column	8	1.50	1.50	0.15	2.70		
		2	1.20	1.20	0.15	0.43		
	for grade beam - main wall alround	1	27.92	0.45	0.10	1.26		
	D/F Column	10	0.30	0.23	0.10	0.07		
	Flooring	1	7.50	6.00	0.10	4.50		
	Ramp	1	4.50	3.80	0.10	1.71		
						10.67	891.00	9506
3	Cement concrete 1:4:8 mix usin 40 mm HBGS metal inculding cost and coveyance of all materials to site including labour for mixing ,laying,curing etc complete.,For Foundation							
	Column	8	1.50	1.50	0.10	1.80		
		2	1.20	1.20	0.10	0.29		
	for grade beam - main wall alround	1	27.92	0.45	0.10	1.26		
	D/F Coumn	10	0.30	0.23	0.10	0.07		
	Flooring	1	7.50	6.00	0.10	4.50		
	Ramp	1	4.50	3.80	0.10	1.71		
						9.63	4123.59	39710
4	Brick work with cement mortar 1:5 mix using II class bricks for foundation and basement and superstructure inculding cost and conveyance of all materiales curing etc ,complete.(above basement)							
	Main wall alround	1	27.92	0.23	4.65	29.86		
	D/F Coumn	8	0.23	0.23	4.65	1.97		

8	Granolithic flooring with CC 1:2:4 including all labour Charges etc., 25mm thick								
	Hall	1	1.00	7.50	6.00	45.00	130.67	5880	
9	Plastering with cement c.m 1:5 including all labour charges ect.,								
	Basement outer alround	1	1	28.84	4.65	134.11			
	Pillasters	8	1.00	0.07	4.65	2.60			
	Inner alaround	1	1.00	27.00	4.20	113.40			
	D/F Main gate	1	2.00	3.60	4.20	30.24			
	D/F Window	9	2.00	1.20	1.30	3.12			
	D/F Vantilater	9	2.00	1.20	0.90	19.44			
						182.35	192.10	35029	
10	Supplying, fabricating, erecting structural steel work for roofing welded or bolted type using MS channels, angles, plates and round bars etc. conforming to IS specification including primer coating and enamel painting as per Design given by the departmental officers etc,complete as per standard specification								
	a)Steel truss work	1	1.00	1208.00			79.60	96157	
	b)Galvanium iron sheets	1		86.69		/sqm	650.00	56349	
11	Supplying, fabricating, erecting structural steel work for welded or bolted type using MS channels, angles, plates and round bars etc. conforming to IS specification including primer coating and enamel painting as per Design given by the department								
	Main Gate	1	4.20	3.60				31000	
	Steel Window	9	1.20	1.30		5765.00	1No	51885	
	Steel Ventilater	9	1.20	0.90		2400.00	1No	21600	
	Exhaust Fan -SD 116	2				1956.00	1No	3912	
12	Painting to coats over new iron works using ready mix enmal paint including all lobour charges etc.,								
	Main Gate	2	4.20	3.60		30.24			
	Steel Window	18	1.20	1.30		28.08			
	Steel Ventilater	18	1.20	0.90		19.44			
						77.76	117.30	9121	
13	Exterior Emulsion two coats with best approved paint including conveyance all materials etc., complete								
	As per Plastering area					182.35	190.55	34747	
	Name board							4500	
	Photographic charges							500	
14	Electrification charges					L.S		15000	
15	Service connection charges					L.S		15000	
								812995	
16	Provision for GST 12%							92718	
17	Provision for Escalation Cost 7%							54086	
	Contingencies							201	
	Total								960000
(Rupees Nine lakhs and Fifty Thousand only).									

P. AMUDHA
PRINCIPAL SECRETARY TO GOVERNMENT

//True copy//

SECTION OFFICER.



Annexure-II

G.O.(Ms). No.139, Rural Development and Panchayat Raj (CGS.1) Department, dated 01.12.2021.

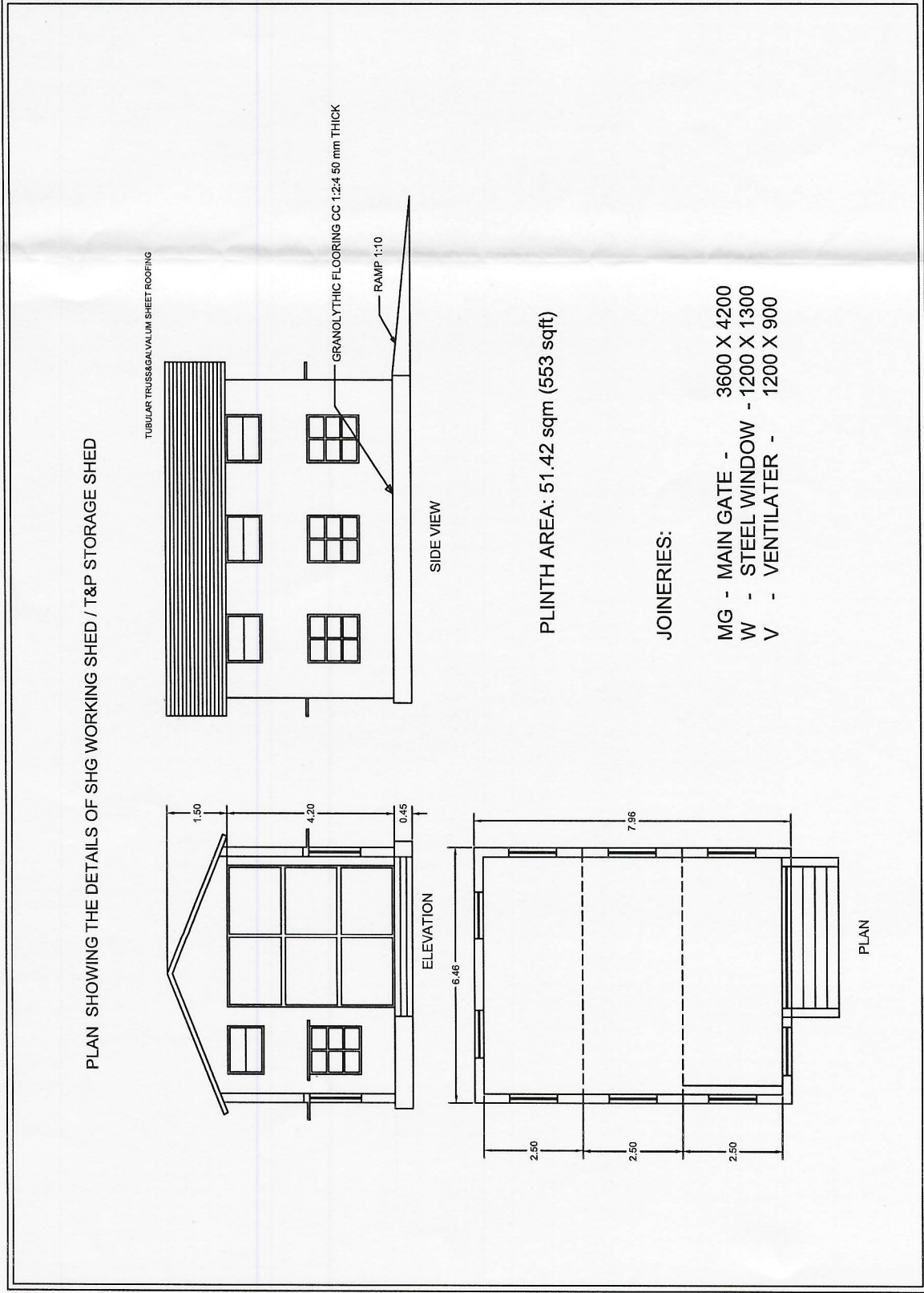

//True copy//

P. AMUDHA,
PRINCIPAL SECRETARY TO GOVERNMENT

MA
SECTION OFFICER.

PROPOSAL TO CONSTRUCT A COMMUNITY CENTRE



A - COMMUNITY CENTRE
 B - PARKING AREA
 C - EXISTING ROAD

SCALE: 1:100

DATE: 15/03/2024

STELLUM CONSULTING

STELLUM CONSULTING, 123 MAIN STREET, SUITE 101, JOHANNESBURG, SOUTH AFRICA

011 123 4567

Annexure-III

G.O.(Ms). No.139, Rural Development and Panchayat Raj (CGS.1) Department, dated 01.12.2021.

Model Estimate for Construction of Sericulture Shed under Mahatma Gandhi Nregs

Estimate Amount Rs:- 692000.00

SI No	Quantity	Description	Rate	Unit	Amount
1		Earth work excavation for foundation in all soils and sub-soils to full depth as may be directed except in hard rock requiring blasting but inclusive of shoring, strutting and bailing out water wherever necessary and refilling the sides of foundation with excavated earth in layers of not more than 15 cm thick well rammed and consolidate and depositing the surplus earth in all places shown by the departmental officers with initial lead and lift etc., complying with standard specification as per SS20 B.			
	3.92	0.00 - 0.30m Depth	260.56	Cum	1021.00
	4.20	0.30 - 0.60m Depth	321.64	Cum	1351.00
	8.40	Above 0.60m Depth	334.06	Cum	2806.00
2	11.60	Plain Cement Concrete 1:4:8 Using 40 mm HBG metal for basement and flooring layers not more than 15cm thick including cost and conveyance of materials to site and all other labour charges including consolidation as per standard specification.	4123.59	Cum	47834.00
3	3.19	Brick work in cement mortar 1:5 using country bricks of size 83/4"x41/4"x23/4" etc., complete and all other labour charges as per standard specification.	5007.64	Cum	15974.00
4	17.88	Cement concrete Solid Block in Cement Mortar 1:5 (one cement and five sand) using ground molded of size 40x20x15 cm. Including cost and conveyance of materials to site and all other labour charges as per standard specification.	2580.09	Cum	46132.00
5	118.06	Centering shuttering including necessary support for plane surface in Foundation and Basement and in all floors using mild steel sheets of size 90x60 cm and 10 gauge stiffened, welded with steel angles of size 25mmx25mm x3mm for boarding laid over silver oak (country wood) joints of 10cm size x6.5cm size spaced at about 90 cm center to center and supported casuarina props of 10 cm to 13 cm dia spaced at 75 cm center to center complete complying with standard specification.	752.00	Sqm	88781.00
6	1.13	Supplying fabricating and placing in position mild steel or ribbed steel for all reinforced cement concrete works as per the design given including cost of steel and binding wire in all floors etc. complete complying with standard specification	68875.45	kg	78157.00
7	10.90	Reinforced Cement concrete 1:2:4 using 20mm, gauge machine broken hard granite stone jelly for all RCC items of works excluding cost of reinforcement and fabricating charges, centering and shuttering but including curing and providing fixtures like fan clamps in the RCC floor or roof slabs wherever necessary and bearing surfaces of walls, sides and bottom of the slabs, beams etc. shall be finished smooth with CM 1:3 12mm thick and with kraft paper without claiming extra etc. as directed by the Departmental officers complete complying with standard specification.	6759.34	Cum	73677.00
8	92.96	Providing granolithic floor finish in cement concrete 1:2:4 mix using 10-12mm ISS metal to 25mm thick including cost and conveyance of all materials to site and all labour charges for mixing, laying, curing etc complete for 10 cum	130.67	Sqm	12147.00
9	170.74	Plastering in CEMENT MORTAR 1:5 12mm thick in Including cost and conveyance of materials to site and all other labour charges including etc., as per standard specification.	192.10	Sqm	32799.00
10		supply and Delivery of Wooden door and Windows with Net including cost and conveyance of all materials to site etc			
	1.00	Door D 1.70 x 2.30	6040.00	No	6040.00
	13.00	Window 0.90 X 1.20	4035.00	No	52455.00
11	153.67	White Wasing two coats of Plastered Wall Surface for using Shell Lime including all cost and conveyance etc.,	26.20	Sqm	4026.00
12	1257.84	Supplying and Fixing of Trusses with Purlines including cost of all materials conveyance and Labour Charges etc., Complete as per Standard Specification.	38.40	Kg	48301.00
13	14.60	Supplying and fixing of MS pipe of 40mm including cost of materials labours and Conveyance etc.,	LS		2500.00

14	14.60	Supplying and fixing of PVC Enhancing pipe of 40mm including cost of materials labours and Conveyence etc.,	LS		2000.00
15	122.84	Supplying and fixing of AC Sheets including cost of materials labours and Conveyence etc.,	Ls		58000.00
16	Ls	Provision for Name board			3000.00
17	Ls	Provision for Photographic Charges			500.00
18	Ls	Provision for Electrification charges			5000.00
19	Ls	Provision for GST 12.00%			68679.00
20	Ls	Escalation Charges 7%			40063.00
21	LS	Contingencies and other unforeseen Items			757.00
Total					692000.00

P. AMUDHA
PRINCIPAL SECRETARY TO GOVERNMENT.

//True copy//



SECTION OFFICER.

G.O.(Ms). No.139, Rural Development and Panchayat Rai (CGS.1) Department, dated 01.12.2021.

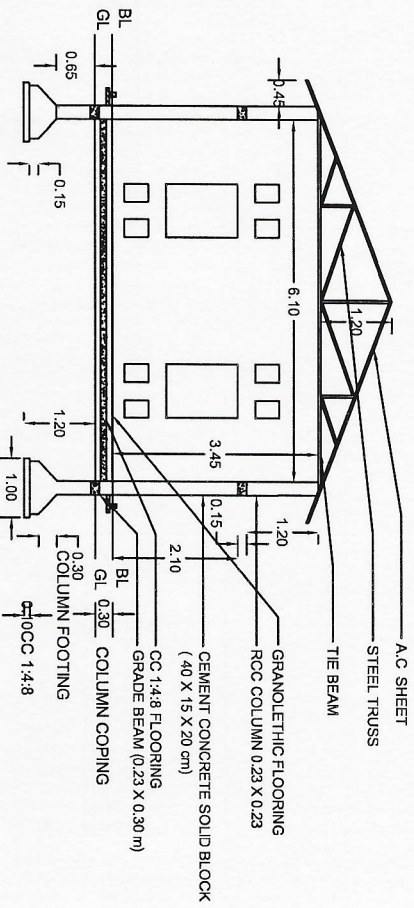
CONSTRUCTION OF SERICULTURE SHED

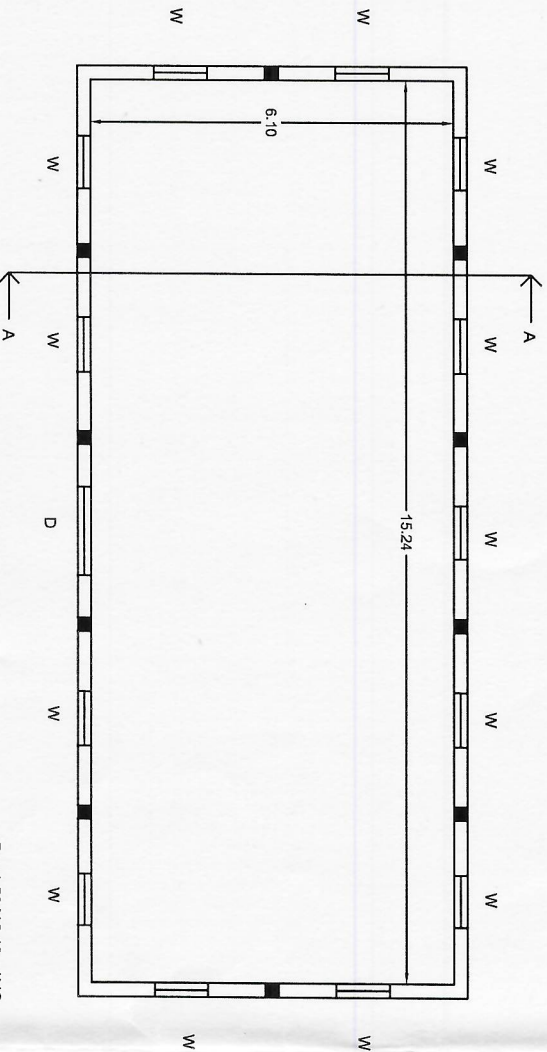

CROSS SECTION A-A



PLAN

D = 1.50 X 2.10 - 1NO.
 W = 0.90 X 1.20 - 13 NOS.
 O = 0.30 X 0.40 - 26 NOS.

//True copy//

P. AMUDHA,
 PRINCIPAL SECRETARY TO GOVERNMENT

SECTION OFFICER

PLAN



CROSS SECTION A-A



CONSTRUCTION OF SERICULTURE SHED

Subject: Agricultural Engineering and Construction, Page No. 11/02/2024, Date: 11/11/2024

Signature

Designed by

Signature

Annexure-V

G.O.(Ms). No.139, Rural Development and Panchayat Raj (CGS.1) Department, dated 01.12.2021.

Model Estimate for Construction of Mushroom shed under Mahatma Gandhi NREGS

Estimate Amount : 225000 /-

Sl. No.		No.	Length	Breadth	Depth	Contents	Amount
1	Light Jungle clearance including all charges etc., complete						
	Jungle clearance	1	1	14.00	9.000		126.00
							126.00
			126.00	Cum @ Rs.	18.26	per m³	2301
2	Earth work excavation and depositing on bank with in initial lead of 10 mand initial lift of 2m in hard stiff clay, stiff black soil as per SS 20A.						
	Wall allround	1	1	28.54	0.340	0.30	2.91
	Deduct Pillars for steel post	-1	12	0.45	0.340	0.30	-0.55
	Pillar for steel post	1	18	0.45	0.450	0.30	1.09
	Bed Cultivation	1	1	12.45	3.600	0.30	13.45
	Wall alround Bed cultivation	1	1	30.04	0.340	0.30	3.06
							19.96
			19.96	Cum @ Rs.	260.56	per m³	5201
3	Earth work excavation and depositing on bank with in initial lead of 10 mand initial lift of 2m in hard stiff clay, stiff black soil as per SS 20A.						
	Bed Cultivation	1	1	12.45	3.600	0.30	13.45
							13.45
			13.45	Cum @ Rs.	321.64	per m³	4326
4	Collection and supply of sand filling into the basement including cost and conveyance to the site and all charges for filling as per standard specfication.						
	Wall allround	1	1	28.54	0.340	0.100	0.97
	Floor	1	1	9.93	4.340	0.100	4.31
	Deduct Pillars for steel post	-1	12	0.45	0.340	0.100	-0.18
	Pillar for steel post	1	18	0.45	0.450	0.100	0.36
	Wall alround Bed cultivation	1	1	30.04	0.340	0.100	1.02
							6.48
			6.48	Cum @ Rs.	891.00	per m³	5774
5	Cement concrete 1:4:8 mix using 40mm ISS metal including cost and conveyance of all materials to site and all labour charges for mixing,laying and curing etc complete for 10 cum.						
	Wall allround	1	1	28.54	0.340	0.075	0.73
	Floor	1	1	9.93	4.340	0.075	3.23
	Deduct Pillars for steel post	-1	12	0.45	0.340	0.075	-0.14
	Pillar	1	18	0.45	0.450	0.075	0.27
	Wall alround Bed cultivation	1	1	30.04	0.340	0.075	0.77
							4.86
			4.86	Cum @ Rs.	4123.59	per m³	20041
6	Brick work in CM 1:5 mix using country bricks ground moulded of size 23 x 11.5 x 7.5cm for the following including curing etc., complete complying with standard specifications.						
	Wall allround footing	1	1	28.54	0.23	0.300	1.97
	Wall allround	1	1	28.54	0.115	0.30	0.98
	Deduct opening	-1	2	0.90	0.115	0.30	-0.06
	Wall alround Bed cultivation	1	1	30.04	0.115	0.90	3.11
	Cable wall for bed cultivation	2	0.393	3.05	0.115	3.05	0.84
	Brick Pillar Wall corner for bed cultivation	1	4	0.12	0.115	0.90	0.05
	Brick pillar Wall centre for bed cultivation	1	4	0.23	0.115	0.90	0.10
	Deduct opening	-1	1	0.90	0.115	0.90	-0.09
							6.90
			6.90	Cum @ Rs.	4948.44	per m³	34144
7	Plastering with CM 1:5, 12mm thick over the cement concrete for floor finish including curing etc., complete complying with standard specifications.						
	Side wall alround	1	2	29.46		0.60	35.35
	Flooring	1	1	9.93	4.34		43.10
	Deduct opening	-1	4	0.90		0.60	-2.16
	Wall alround Bed cultivation	1	1	30.50		0.90	27.45
	Brick pillar bed cultivation	1	4	0.46		1.20	2.21
	Brick pillar wall corner bed cultivation	1	4	0.23		1.20	1.10
							107.05
			107.05	Sqm @ Rs.	192.10	per m²	20564

Sl. No.		No.	Length	Breadth	Depth	Contents	Amount
8	Colour washing two coat with shell lime including cost and conveyance of all materials and all labour charges etc., complete.						
	Side wall around bed preparation shed	1	2	29.46		0.60	35.35
	Deduct opening	-1	4	0.90		0.60	-2.16
	Wall around Bed cultivation	1	1	30.50		1.20	36.60
	Brick pillar cultivation	1	4	0.46		0.90	1.66
	Brick pillar corner cultivation	1	4	0.23		0.90	0.83
							72.28
				72.28	Sqm @ Rs.	39.30	per m²
							2841
9	Reinforced cement concrete 1:1.5:3mix using 20mm ISS metal including cost and conveyance of all materials to site and all labour charges for mixing, laying, and curing etc complete for 10 cum						
	Pillar for steel post	1	18	0.30	0.30	0.45	0.73
							0.73
				0.73	Cum @ Rs.	7323.31	per m³
							5346
10	Supply and fabrication of steel grill work including cost and all labour charges for fabrication etc., complete.						
	Supply & delivery of the 60mm dia MS pipe	1	12	3.50		4.05	170.10
	Supply & delivery of the 60mm dia MS pipe	1	6	5.00		4.05	121.50
	Steel door	1	1	1.00		20.00	20.00
	8mm dia steel rod bed cultivation Curve	1	15	4.79		0.39	28.02
	8mm dia steel rod bed cultivation L/W	1	5	12.20		0.39	23.79
	Steel door	1	1	1.00		20.00	20.00
							383.41
				383.41	kg	92.90	per kg
							35619
11	Common Thatched roofing with coconut leaves including rafters and reepers and mats						
	Roof	1	2	10.66	2.55		54.37
	Side around	1	1	10.66		2.85	30.38
							84.75
				84.75	Sqm @ Rs.	499.90	Sqm
							42367
12	Tarpaulin sheet for Mushroom cultivation						
	Roof bed cultivation	1	1	3.05	12.20		18.61
							18.61
				18.61	Sqm @ Rs.	422.02	Sqm
							7854
13	Provision for Door						L.S
14	Citizen Information Board						1000
15	Provision for electrification charges						L.S
16	Escalation Cost 7%						2000
17	GST 12%						12534
18	Provision for photographic charges						L.S
19	Contingencies						L.S
							463
							225000
							Total
							225000

P. AMUDHA,
PRINCIPAL SECRETARY TO GOVERNMENT.

//True copy//

SECTION OFFICER.

Annexure-VI

G.O.(Ms). No.139, Rural Development and Panchayat Raj (CGS.1) Department, dated 01.12.2021.

CONSTRUCTION OF MILKY MUSHROOM SHED

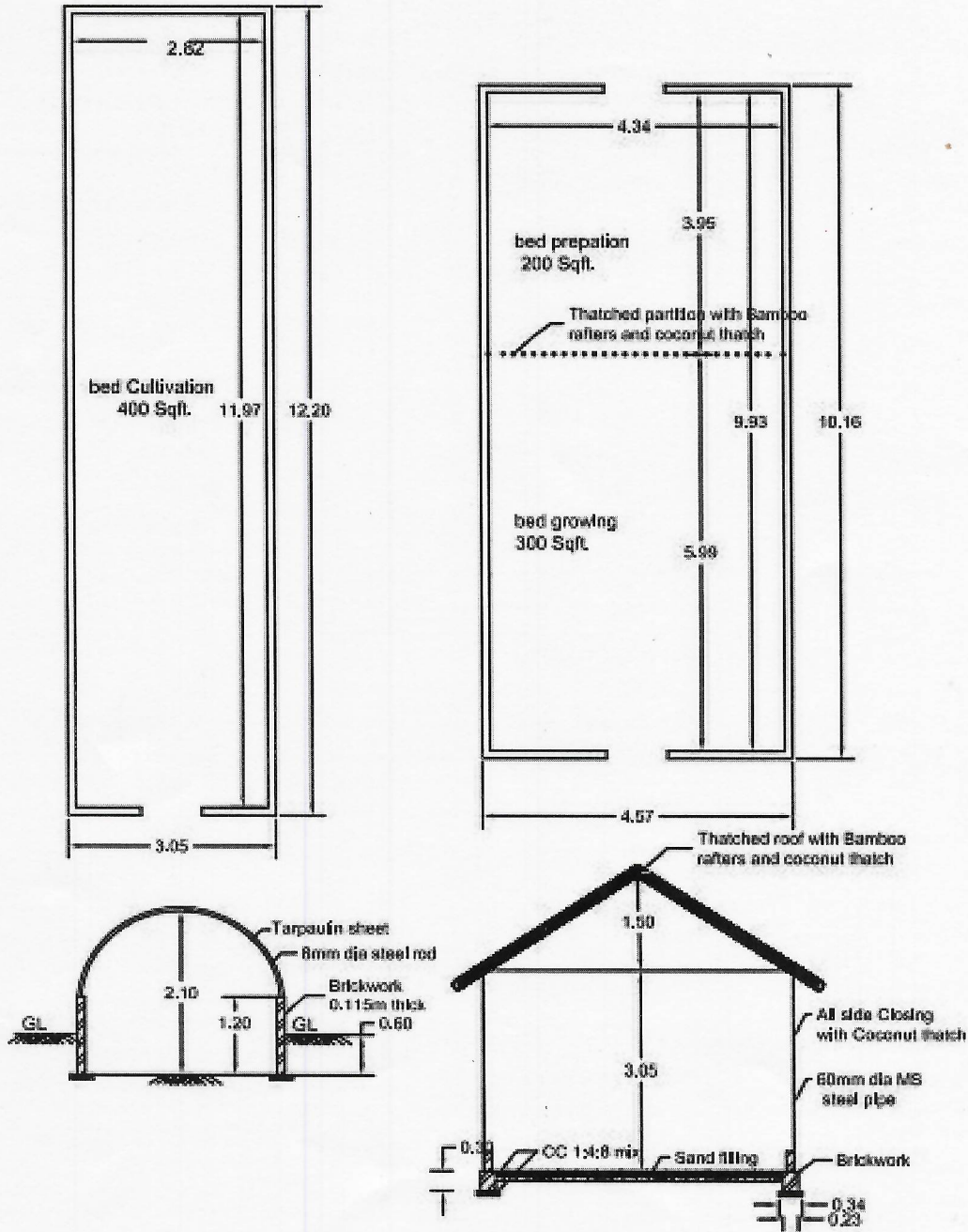

P. AMUDHA,
PRINCIPAL SECRETARY TO GOVERNMENT

//True copy//

[Signature]
SECTION OFFICER.



